

SMART SEAL Temperature Alarm System

PRODUCT OVERVIEW

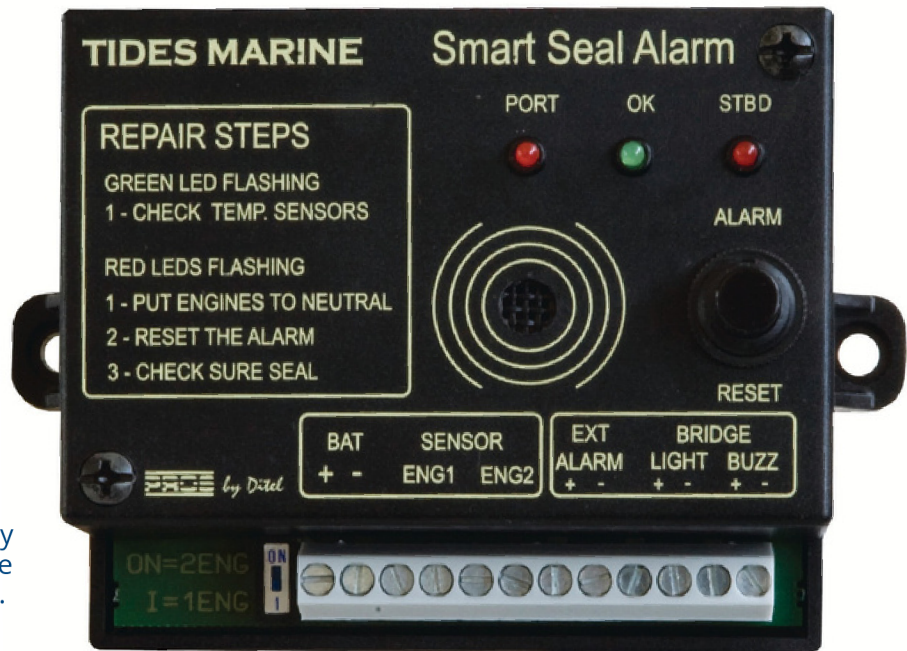

The control module accepts a 12V or 24V DC power supply and has a self-diagnostic facility on power-up to ensure that the system is functioning correctly.

Working together with temperature measurement specialists, Pros by Ditel, Tides Marine has developed a temperature alarm system to work in conjunction with the Tides SureSeals® running on commercial and pleasure craft with single- or twin-engine installations.

The SMART SEAL is designed to monitor SureSeal® head temperature using a solid state sensor, electronic control module and a remote alarm panel or warning siren.

Any increase in the normal operating temperature of the shaft seal will trigger an audible and visual alarm. This alarm will notify the owner and crew that an immediate inspection of the SureSeal(s)™ is required to prevent damage to the SureSeal.

The control module accepts a 12V or 24V DC power supply and has a self-diagnostic feature on power-up that indicates the system is functioning properly.

SMART SEAL Temperature Alarm System

Smart Seal FEATURES	Smart Seal BENEFITS
Provides early warning of overheating. →	<ul style="list-style-type: none"> • SMART SEAL detects excessive increases in water temperature within the shaft seal or forward part of the stern tube. • Any interruption to the cooling water supply or the stern tube being blocked will cause the alarm to sound.
Low maintenance. →	<ul style="list-style-type: none"> • Solid state sensor with no moving parts—mounts to water injection fitting on SureSeal® unit. • Control module has self-diagnostic test on power-up. • 2-year warranty.
Easy to install. →	<ul style="list-style-type: none"> • Control module mounts to engine room bulkhead. • Suitable for single- or twin-engine installations. • Sensors pre-wired with 10 meters of heat-resistant cable, allowing convenient control panel location. • Remote panel designed for mounting at helm position.
Compatibility. →	<ul style="list-style-type: none"> • Control module has output for optional remote siren or for connection to on-board warning/alarm system. • Suitable for 12V and 24V DC operation. • Can be retro-fitted to any Tides Marine SureSeal® unit already in service.
Simple operation. →	<ul style="list-style-type: none"> • Green 'OK' light to confirm that the system is functioning correctly. • Control module identifies which shaft seal is starting to overheat. • "RESET" button to cancel alarm events. • Memory re-activates alarm after power interaction .

Configuration for 1 or 2 Engines:

The module allows the operator to set the unit for either single- or twin-engine installation. Before connecting the module to the power supply, use the toggle switch to indicate single or dual operation.

For single engine applications, connect the sensor to "ENG 1" (PORT).

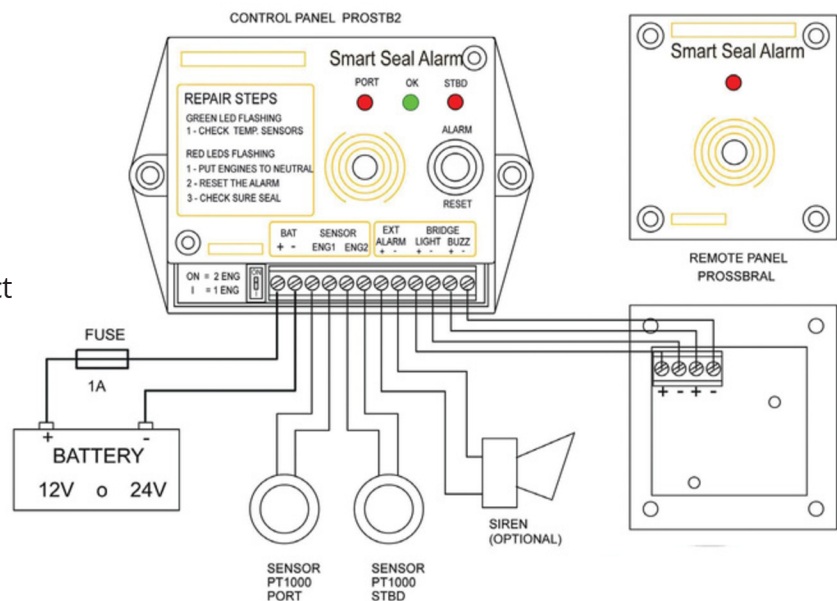

SMART SEAL Temperature Alarm System

Remote Panel for PROSTB2 Model PROSSBRAL

- Aluminum face plate 60 mm x 65 mm / 2.36" x 2.56"
- 4 screws 3.5 x 16
- 1 red LED
- 1 buzzer 104 dB
- 1 connector block
- Not waterproof

Allows a remote repetition of the acoustic signal and visual alarm (red LED), generated by the PROSTB2 module. The connection between modules can be wired with 4 x 1 mm² as per instructions (not included in kit).



Optional Siren for PROSTB2 Model PROSSIRDC

- 1 siren 12V/24V DC
- 1 instruction manual
- Not waterproof

The siren can be connected to a 12V or 24V supply and is easily connected to the main module PROSTB2 as per instructions.

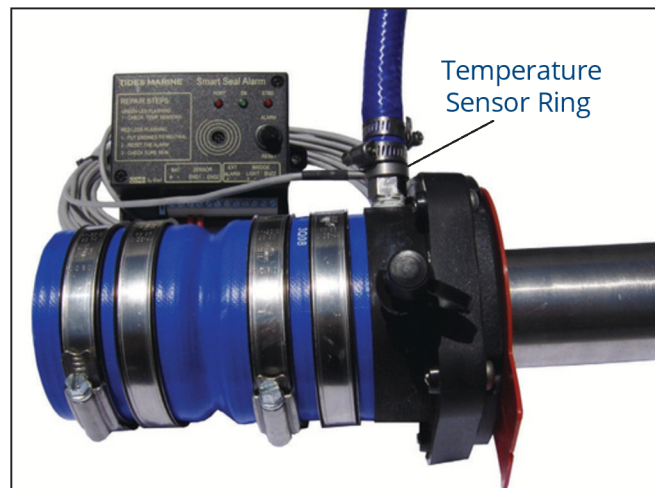

Notes

Notes

TIDESMARINE

Contact Information

CLOUDS INTERNATIONAL B.V

1e Industrieweg 6A

3411 MG LOPIK

0031348551644

mail@clouds.nl | verkoop@clouds.nl

